

“The dinner was an undoubted success and this was due, in no small way, to your careful planning, supervision and co ordination”

LIEUTENANT COLONEL G A MIDDLEMISS KOSB
DIVISIONAL LIEUTENANT COLONEL

“highest standards”

“Our meal was superb and everyone commented on the friendliness and efficiency of the staff”

CHARLES RITCHIE
PROSOYA EUROPE PLC



CONFERENCE & BANQUETING

Our satisfied customers speak for themselves

“I would like to say how much everyone enjoyed the evening and the food was acclaimed on all sides”

BRIAN ADAIR
DIRECTOR, RYDEN LETTINGS

“The atmosphere at The Royal Scots Club was so pleasant and the meeting rooms were perfect and all beautifully laid out”

MAXINE VLIELAND
THE KÖNIGSWINTER CONFERENCE

“delicious food”



THE
ROYAL SCOTS
CLUB

EDINBURGH

Patron: H.R.H. The Princess Royal K.G., G.C.V.O.

30 Abercromby Place Edinburgh EH3 6QE

Tel: 0131 556 4270 Fax: 0131 558 3769

“The service was excellent and the standards were as usual impeccable”

DAVID MCARTHUR
HEALTHCARE DEVELOPMENT MANAGER

THE ROYAL SCOTS CLUB
EDINBURGH

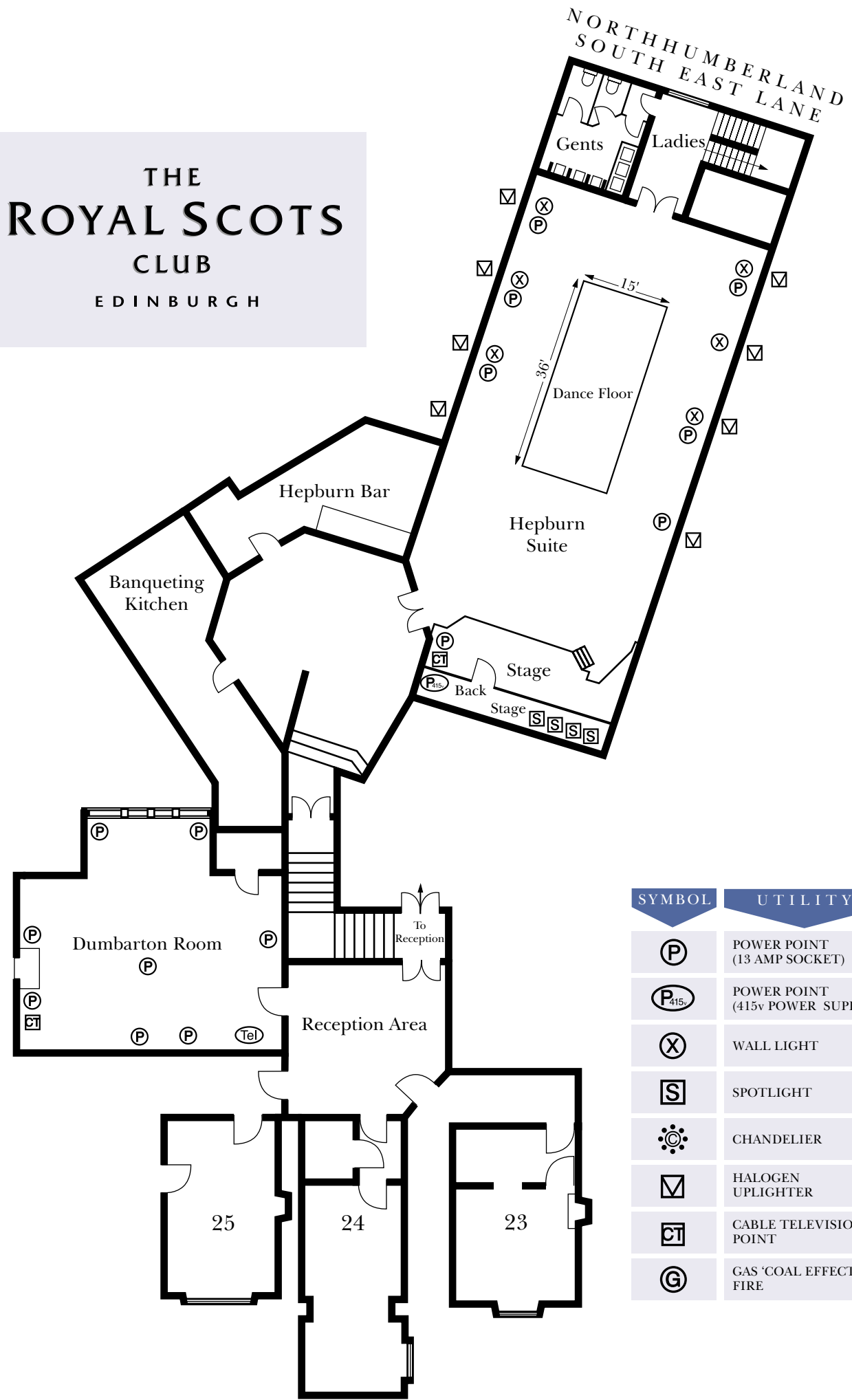

Syndicate Rooms

SYMBOL	UTILITY
(P)	POWER POINT (13 AMP SOCKET)
(P ₄₁₅)	POWER POINT (415v POWER SUPPLY)
(X)	WALL LIGHT
(S)	SPOTLIGHT
(Sunburst)	CHANDELIER
(Square with X)	HALOGEN UPLIGHTER
(CT)	CABLE TELEVISION POINT
(G)	GAS 'COAL EFFECT' FIRE

QUEEN STREET GARDENS
ABERCROMBY PLACE

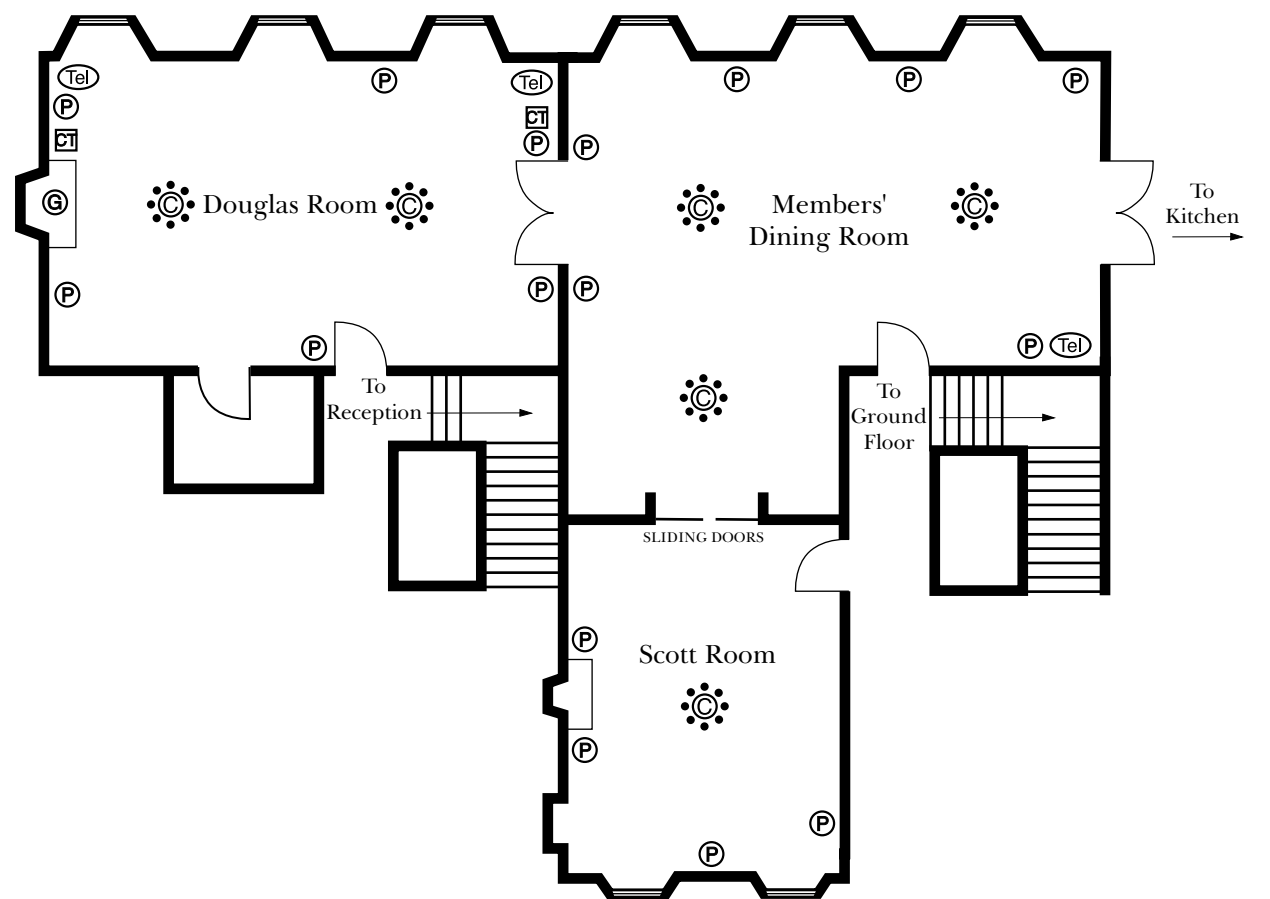

ROOM	SEATING STYLE				
	THEATRE	CLASSROOM	BOARDROOM	FORMAL	U SHAPED
HEPBURN	150	40	40	110	38
DUMBARTON	60	20	30	50	24
DOUGLAS	50	20	28	45	24
SCOTT	20	10	20	20	12

ROOM	DIMENSIONS	
	FLOOR AREA	ROOM DOOR DIMENSIONS
HEPBURN	47' x 25' 6"	North Door 51"W x 87"H South Door 49"W x 87"H Back Door to Lane 62"W x 95"H
DUMBARTON	28'6" x 23' 6"	36"W x 84"H
DOUGLAS	30' x 18' 6"	41"W x 94"H Door to Dining Room 72"W x 97" H
SCOTT	24'6" x 18' 6"	36"W x 91"H